

# 8G24

## SPECIFICATIONS

|                              |                               |
|------------------------------|-------------------------------|
| Nominal Voltage (V)          | 12V                           |
| Capacity at C/100            | 84.5 Ah                       |
| Capacity at C/20             | 73.6 Ah                       |
| Capacity at C/5              | 63 Ah                         |
| Weight                       | 51.5 lbs. (23 kg)             |
| Plate Alloy                  | Lead Calcium                  |
| Posts                        | Forged Terminals & Bushings   |
| Container/Cover              | Polypropylene                 |
| Operating Temperature Range  | -76°F (-60°C) - 140°F (60°C)  |
| Charge Voltage @ 77°F (25°C) |                               |
| Cycle                        | 13.8 - 14.6 volts             |
| Float                        | 13.4 - 13.6 volts             |
| Vent                         | Self-sealing                  |
| Electrolyte                  | Sulfuric acid thixotropic gel |
| Terminal                     | G (T881)                      |

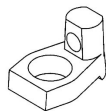

Rated non-spillable by ICAO, IATA and DOT

Made in the U.S.A. by East Penn Manufacturing Co, Inc.

## Valve-Regulated, Gelled-Electrolyte Battery



## DIMENSIONS

*Inches (mm)*

|        |   |
|--------|---|
| Length | 10.20 (259 mm)                              |
| Width  | 6.56 (167 mm)                               |
| Height | 9.27 (235 mm)<br><i>Including terminals</i> |

**Gel Cycle Life vs Depth of Discharge at +25°C (77°F)**  
Based on BCI 2-hour Capacity

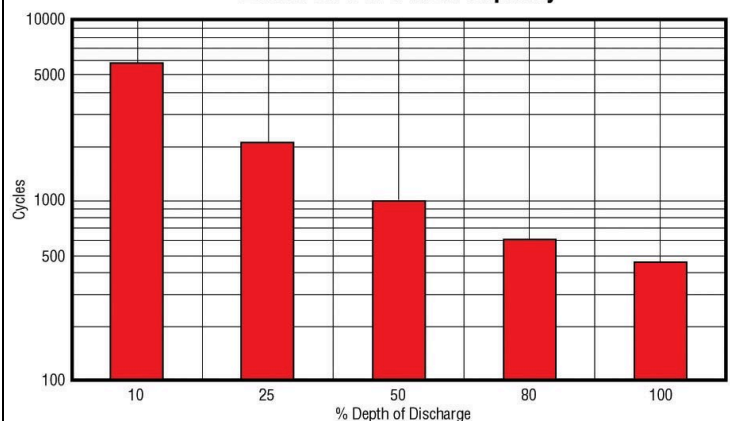

## MK Battery

1631 South Sinclair Street • Anaheim, California 92806

Toll Free: 800-372-9253 • Fax: 714-937-0818 • E-mail: sales@mkbattery.com

