



ES12-12TE

SPECIFICATIONS

Nominal Voltage (V) 12V

Nominal Capacity

20 hour rate (0.6A to 10.50V)	12Ah
10 hour rate (1.14A to 10.50V)	11.4Ah
5 hour rate (2.04A to 10.20V)	10.2Ah
1C (12A to 9.60V)	6.8Ah
3C (36A to 9.60V)	4.8Ah

Weight Approx. 8.84Lbs. (4.02kg)

Internal Resistance (at 1KHz) Approx. 11 mΩ

Maximum Discharge Current for 5 seconds : 240A

Operating Temperature Range

Charge	-15°C (5°F) to 40°C (104°F)
Discharge	-15°C (5°F) to 50°C (122°F)
Storage	-15°C (5°F) to 40°C (104°F)

Charge Retention (shelf life) at 20°C (68°F)

1 month	92%
3 months	90%
6 months	80%

Charging Methods at 25°C (77°F)

Cycle Use : Charging Voltage 14.4 to 15.0V
Coefficient -5.0mv / °C / cell
Maximum Charging Current : 3.6A

Standby Use : Float Charging Voltage 13.50 to 13.80V
Coefficient -3.0mv / °C / cell

Case Material : ABS
(Option : UL94 HB Flame Retardant Case Material)

Terminal : F3

Maintenance-Free Rechargeable Sealed Lead-Acid Battery



DIMENSIONS

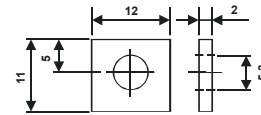

F3
(M5 Bolts)

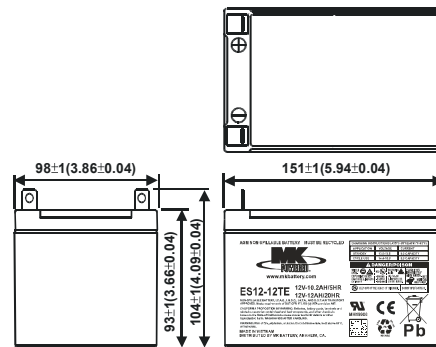

(V) FOR 12V BATTERY **Discharge Time VS. Discharge Current (25°C)**

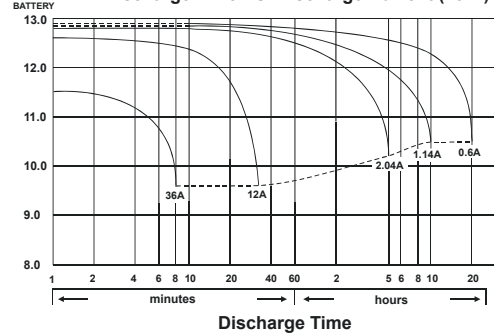

MK Battery

1631 South Sinclair Street • Anaheim, California 92806

Toll Free: 800-372-9253 • Fax: 714-937-0818 • E-mail: sales@mkbattery.com

