



# 12LCP-15

12V 15Ah



Q-Batteries Akku 12LCP-15 battery is a special deep cycle battery which is designed for intensive cyclic discharge usage. Because of the very thick lead plates it's possible to achieve more cycles and longer lifetime.

## Application:

Electric wheelchair, caravan/marine, cleaning machines, golf cart, vehicle lifts, solar energy system, u.v.m.



## Specification:

|                                    |   |                                   |                           |
|------------------------------------|---|-----------------------------------|---------------------------|
| Voltage Per Unit                   | 12 V  |                                   |                           |
| Capacity                           | 15 Ah   | @20hr-rate to 1.8V per cell @25°C |                           |
| Cells Per Unit                     | 6   |                                   |                           |
| Weight                             | ca. 4.5 kg +/- 3%   |                                   |                           |
| Max. Discharge Current             | 140 A (5 sec.)  |                                   |                           |
| Internal Resistance                | ca. 12 m Ω  |                                   |                           |
| Operating Temperature Range Normal | Discharge:<br>- 15°C – 50°C   | Charge:<br>-10°C – 50°C           | Storage:<br>- 20°C – 50°C |
| Operating Temperature Range        | 25°C ± 5°C  |                                   |                           |
| Self Discharge                     | Valve Regulated Lead Acid (VRLA) batteries can be stored for more than 6 months at 25°C. Self-discharge ratio less than 3% per month at 25°C. Please charge batteries before using. |                                   |                           |
| Terminal                           | F2 (Faston 6,35mm)  |                                   |                           |
| Container Material                 | A.B.S. (UL94-HB)  |                                   |                           |

## Dimensions:

151 Length x 98 Width x 99 mm Height

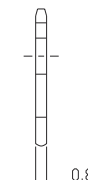
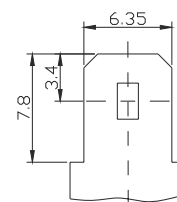
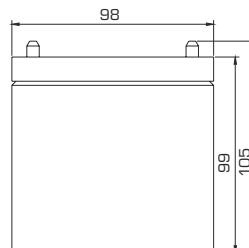
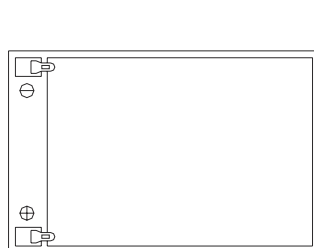
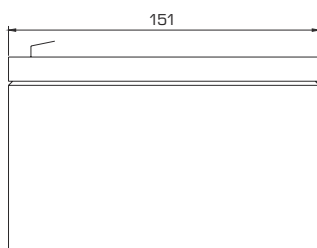

## Constant current discharge characteristics: A (25°C)

| F.V/Time | 5 Min. | 10 Min. | 15 Min. | 30 Min. | 1 HR   | 2 HR  | 3 HR  | 4 HR  | 5 HR  | 8 HR  | 10 HR | 20 HR |
|----------|--------|---------|---------|---------|--------|-------|-------|-------|-------|-------|-------|-------|
| 9.60 V   | 62.77  | 41.40   | 32.68   | 18.89   | 10.342 | 6.329 | 4.365 | 3.381 | 2.778 | 1.778 | 1.553 | 0.847 |
| 10.0 V   | 60.23  | 39.78   | 31.77   | 18.60   | 10.282 | 6.279 | 4.348 | 3.351 | 2.762 | 1.771 | 1.538 | 0.816 |
| 10.2 V   | 56.98  | 38.41   | 30.91   | 18.45   | 10.192 | 6.244 | 4.331 | 3.307 | 2.745 | 1.764 | 1.522 | 0.801 |
| 10.5 V   | 51.47  | 36.08   | 29.16   | 18.03   | 10.055 | 6.180 | 4.291 | 3.275 | 2.726 | 1.757 | 1.506 | 0.770 |
| 10.8 V   | 45.97  | 33.62   | 27.39   | 17.60   | 9.876  | 6.145 | 4.251 | 3.249 | 2.711 | 1.750 | 1.474 | 0.739 |
| 11.1 V   | 40.51  | 31.15   | 25.65   | 17.02   | 9.635  | 6.054 | 4.197 | 3.162 | 2.695 | 1.743 | 1.458 | 0.724 |

## Life characteristics of cyclic use:

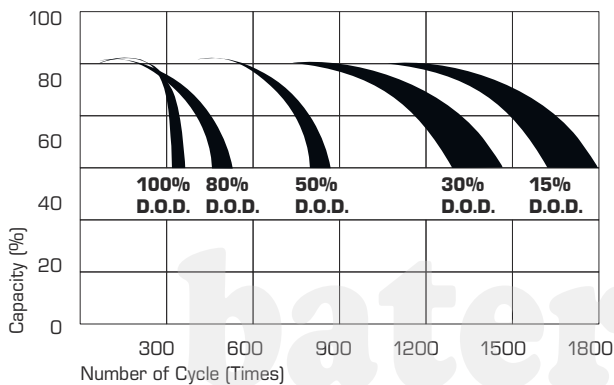

## Storage characteristic:

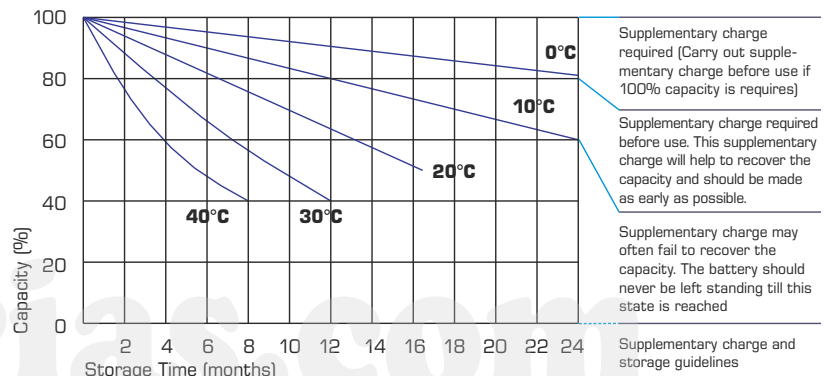

## Capacity Factors with different Temperature:

| Battery Type |          | -20°C | -10°C | 0°C | 5°C | 10°C | 20°C | 25°C | 30°C | 40°C | 45°C |
|--------------|----------|-------|-------|-----|-----|------|------|------|------|------|------|
| GEL Battery  | 6V & 12V | 50%   | 70%   | 83% | 85% | 90%  | 98%  | 100% | 102% | 104% | 105% |
|              | 2V       | 60%   | 75%   | 85% | 88% | 92%  | 99%  | 100% | 103% | 105% | 106% |
| AGM Battery  | 6V & 12V | 46%   | 66%   | 76% | 83% | 90%  | 98%  | 100% | 103% | 107% | 109% |
|              | 2V       | 55%   | 70%   | 80% | 85% | 92%  | 99%  | 100% | 104% | 108% | 110% |

## Charging Method:

Charge the batteries at least once every six months, if they are stored at 25°C

|                      |   |
|----------------------|---|
| Constant Voltage (V) | -0.2C x 2h + 2.4-2.45V/Cell x 24h, max. Current 0.3CA |
| Constant Current (A) | -0.2C x 2h + 0.1CA x 12h                              |
| Fast                 | -0.2C x 2h + 0.3CA x 4.0h                             |