



M20-12 SLD M

SPECIFICATIONS

Nominal Voltage (V) 12V

Nominal Capacity

| | |
|--------------------------------|-------|
| 20 hour rate (1A to 10.50V) | 20Ah |
| 10 hour rate (2A to 10.50V) | 19Ah |
| 5 hour rate (3.4A to 10.20V) | 17Ah |
| 1C (20A to 9.60V) | 9Ah |
| 3C (60A to 9.60V) | 7.0Ah |

Weight Approx. 13.31Lbs. (6.05kg)

Internal Resistance (at 1KHz) 10 mΩ

Maximum Discharge Current for 30 seconds : 400A

Maximum Discharge Current for 5 seconds : 800A

Operating Temperature Range

| | |
|-----------|-----------------------------|
| Charge | 0°C (32°F) to 40°C (104°F) |
| Discharge | -15°C (5°F) to 50°C (122°F) |
| Storage | -15°C (5°F) to 40°C (104°F) |

Charge Retention (shelf life) at 20°C (68°F)

| | |
|----------|-----|
| 1 month | 92% |
| 3 months | 90% |
| 6 months | 80% |

Charging Methods at 20°C (68°F)

Cycle Use : Charging Voltage 14.4 to 15.0V
Maximum Charging Current : 6A

Standby Use : Float Charging Voltage 13.50 to 13.80V

Life expectancy :

Cycle Use : 100% depth of discharge 200 cycles
80% depth of discharge 225 cycles
50% depth of discharge 500 cycles

Standby Use : 3-5 years

Case Material : ABS
(Option : 94-HB & 94V-0 Flame Retardant Case Material)

Terminal : F3

Maintenance-Free Rechargeable Sealed Lead-Acid Battery



DIMENSIONS

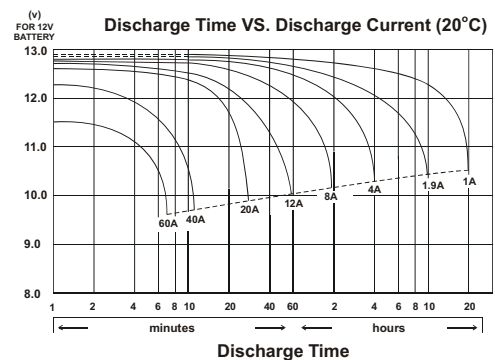
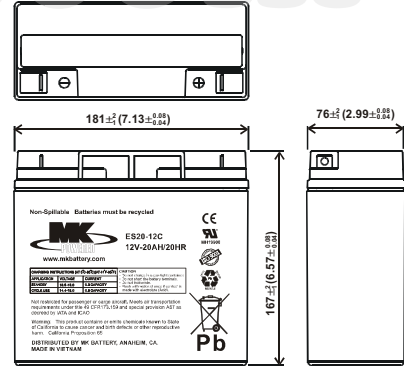
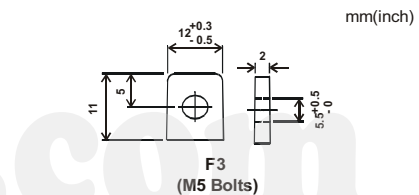

MK Battery

1631 South Sinclair Street • Anaheim, California 92806

Toll Free: 800-372-9253 • Fax: 714-937-0818 • E-mail: sales@mkbattery.com

