



# 12LC-200

12V 214Ah



Q-Batteries Akku 12LC-200 battery is a special deep cycle battery which is designed for intensive cyclic discharge usage. Because of the very thick lead plates it's possible to achieve more cycles and longer lifetime.

## Application:

Electric wheelchair, caravan/marine, cleaning machines, golf cart, vehicle lifts, solar energy system, u.v.m.



## Specification:

Voltage Per Unit	12 V		
Capacity	214 Ah (@10hr-rate to 1.75V per cell @25°C)		
Cells Per Unit	6		
Weight	ca. 60 kg +/- 3%		
Max. Discharge Current	2000 A (5 sec.)		
Internal Resistance	ca. 4 m Ω		
Operating Temperature Range Normal	Discharge: - 15°C – 50°C	Charge: - 10°C – 50°C	Storage: - 20°C – 50°C
Operating Temperature Range	25°C ± 5°C		
Self Discharge	Valve Regulated Lead Acid (VRLA) batteries can be stored for more than 6 months at 25°C. Self-discharge ratio less than 3% per month at 25°C. Please charge batteries before using.		
Terminal	F12 (M8 bolt)		
Container Material	A.B.S. (UL94-HB)		

## Dimensions:

522 Length x 240 Width x 219 mm Height

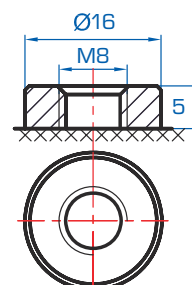
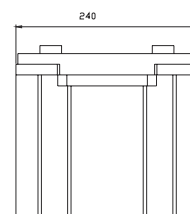
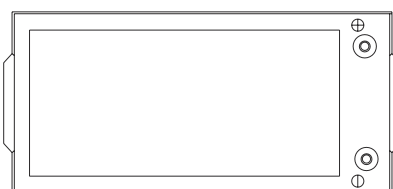
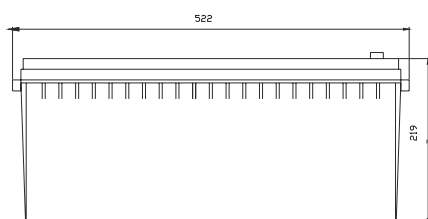

## Constant current discharge characteristics: A (25°C)

FV/Time	5 Min.	10 Min.	15 Min.	30 Min.	1 HR	2 HR	3 HR	4 HR	5 HR	8 HR	10 HR	20 HR
9.60 V	545.12	408.33	344.69	225.33	130.00	77.788	53.766	44.064	36.067	24.844	21.006	11.553
10.0 V	529.36	388.53	337.62	221.61	129.40	77.204	53.560	43.860	35.855	24.642	20.804	11.343
10.2 V	513.67	374.81	332.31	219.65	128.20	76.619	53.148	43.656	35.643	24.440	20.602	11.133
10.5 V	461.25	345.86	316.41	214.16	127.00	76.034	52.942	43.248	35.219	24.238	20.400	10.923
10.8 V	416.33	315.39	291.66	204.76	124.00	74.669	51.500	42.228	34.582	23.834	20.198	10.713
11.1 V	355.48	281.87	261.61	191.83	117.80	71.355	49.234	40.188	33.097	22.824	19.592	10.083

## Life characteristics of cyclic use:

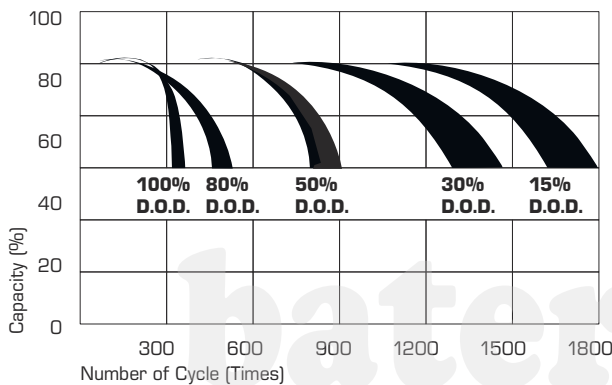

## Storage characteristic:

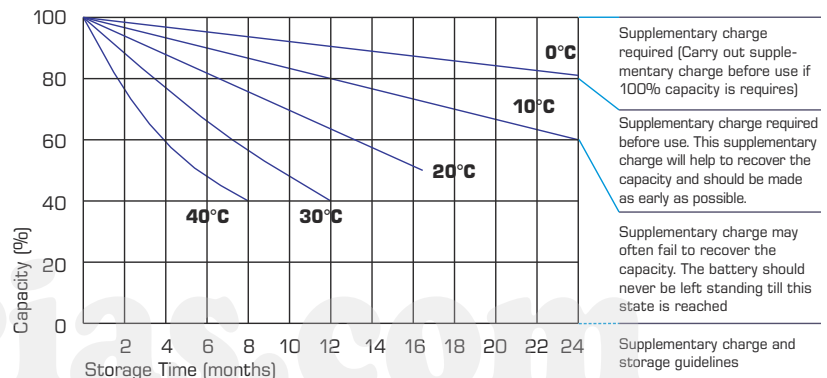

## Capacity Factors with different Temperature:

Battery Type		-20°C	-10°C	0°C	5°C	10°C	20°C	25°C	30°C	40°C	45°C
GEL Battery	6V & 12V	50%	70%	83%	85%	90%	98%	100%	102%	104%	105%
	2V	60%	75%	85%	88%	92%	99%	100%	103%	105%	106%
AGM Battery	6V & 12V	46%	66%	76%	83%	90%	98%	100%	103%	107%	109%
	2V	55%	70%	80%	85%	92%	99%	100%	104%	108%	110%

## Charging Method:

Charge the batteries at least once every six months, if they are stored at 25°C

Constant Voltage (V)	-0.2C x 2h + 2.4-2.45V/Cell x 24h, max. Current 0.3CA
Constant Current (A)	-0.2C x 2h + 0.1CA x 12h
Fast	-0.2C x 2h + 0.3CA x 4.0h