

M24 SLD G

SPECIFICATIONS

Nominal Voltage (V)	12V
Capacity at C/100	84.5 Ah
Capacity at C/20	73.6 Ah
Capacity at C/5	63 Ah
Weight	51.5 lbs. (23 kg)
Plate Alloy	Lead Calcium
Posts	Forged Terminals & Bushings
Container/Cover	Polypropylene
Operating Temperature Range	-76°F (-60°C) - 140°F (60°C)
Charge Voltage @ 77°F (25°C)	
Cycle	13.8 - 14.6 volts
Float	13.4 - 13.6 volts
Vent	Self-sealing
Electrolyte	Sulfuric acid thixotropic gel
Terminal	G (T881)

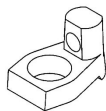

Rated non-spillable by ICAO, IATA and DOT

Made in the U.S.A. by East Penn Manufacturing Co, Inc.

Valve-Regulated, Gelled-Electrolyte Battery



DIMENSIONS

Inches (mm)

Length	10.20 (259 mm)
Width	6.56 (167 mm)
Height	9.24 (235 mm) <i>Including terminal</i>

**Gel Cycle Life vs Depth of Discharge at +25°C (77°F)
Based on BCI 2-hour Capacity**

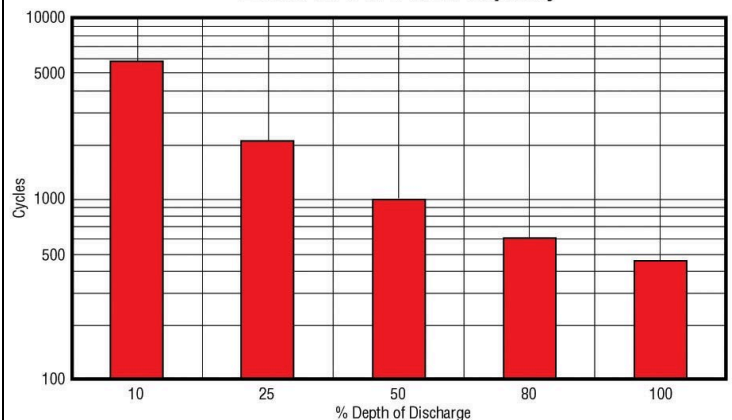

MK Battery

1631 South Sinclair Street • Anaheim, California 92806

Toll Free: 800-372-9253 • Fax: 714-937-0818 • E-mail: sales@mkbattery.com

