



12LCP-36

12V 36Ah



Q-Batteries Akku 12LCP-36 battery is a special deep cycle battery which is designed for intensive cyclic discharge usage. Because of the very thick lead plates it's possible to achieve more cycles and longer lifetime.

Application:

Electric wheelchair, caravan/marine, cleaning machines, golf cart, vehicle lifts, solar energy system, u.v.m.

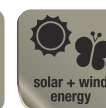

Specification:

Voltage Per Unit	12 V		
Capacity	36 Ah	@20hr-rate to 1.8V per cell @25°C	
Cells Per Unit	6		
Weight	ca. 10,2 kg +/- 3%		
Max. Discharge Current	330 A (5 sec.)		
Internal Resistance	ca. 9 m Ω		
Operating Temperature Range Normal	Discharge: - 15°C – 50°C	Charge: - 10°C – 50°C	Storage: - 20°C – 50°C
Operating Temperature Range	25°C ± 5°C		
Self Discharge	Valve Regulated Lead Acid (VRLA) batteries can be stored for more than 6 months at 25°C. Self-discharge ratio less than 3% per month at 25°C. Please charge batteries before using.		
Terminal	F11 (M6)		
Container Material	A.B.S. (UL94-HB)		

Dimensions:

195 Length x 130 Width x 163 mm Height

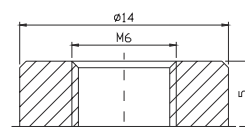
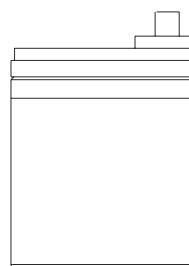
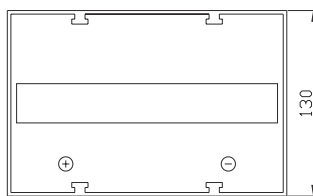
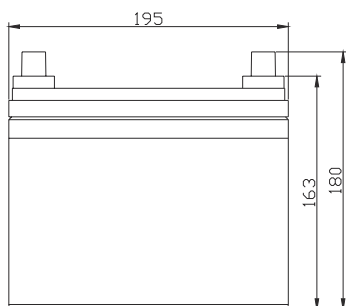

Constant current discharge characteristics: A (25°C)

F.V/Time	5 Min.	10 Min.	15 Min.	30 Min.	1 HR	2 HR	3 HR	4 HR	5 HR	8 HR	10 HR	20 HR
9.60 V	118.3	86.35	65.52	39.20	23.16	13.46	9.301	7.908	6.415	4.226	3.505	1.943
10.0 V	114.9	82.16	64.18	38.52	23.06	13.36	9.266	7.871	6.377	4.191	3.471	1.908
10.2 V	111.5	79.26	63.17	38.01	22.84	13.25	9.194	7.834	6.340	4.157	3.437	1.873
10.5 V	100.11	73.14	60.15	37.53	22.63	13.15	9.159	7.761	6.264	4.122	3.404	1.837
10.8 V	90.36	66.69	55.11	36.88	22.10	12.92	8.909	7.578	6.151	4.054	3.370	1.802
11.1 V	77.15	59.60	49.07	34.53	20.99	12.34	8.517	7.212	5.887	3.882	3.269	1.696

Life characteristics of cyclic use:

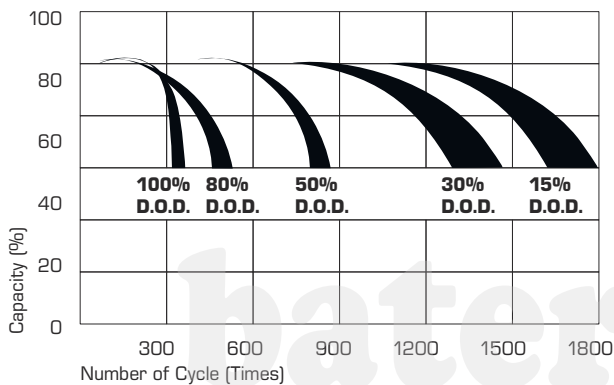

Storage characteristic:

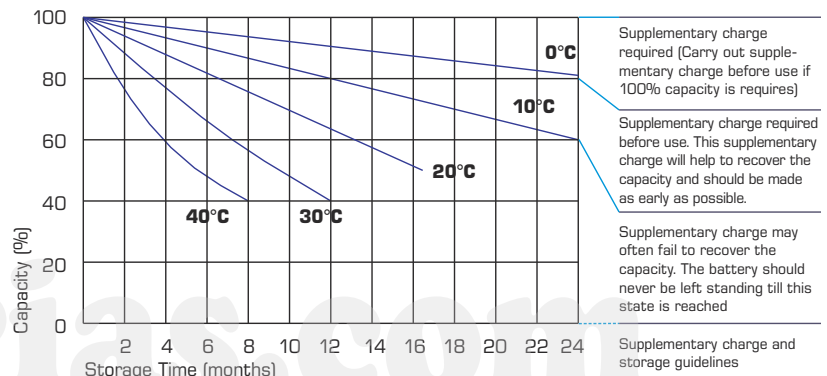

Capacity Factors with different Temperature:

Battery Type		-20°C	-10°C	0°C	5°C	10°C	20°C	25°C	30°C	40°C	45°C
GEL Battery	6V & 12V	50%	70%	83%	85%	90%	98%	100%	102%	104%	105%
	2V	60%	75%	85%	88%	92%	99%	100%	103%	105%	106%
AGM Battery	6V & 12V	46%	66%	76%	83%	90%	98%	100%	103%	107%	109%
	2V	55%	70%	80%	85%	92%	99%	100%	104%	108%	110%

Charging Method:

Charge the batteries at least once every six months, if they are stored at 25°C

Constant Voltage (V)	-0.2C x 2h + 2.4-2.45V/Cell x 24h, max. Current 0.3CA
Constant Current (A)	-0.2C x 2h + 0.1CA x 12h
Fast	-0.2C x 2h + 0.3CA x 4.0h