



12LCP-60

12V 63Ah



Q-Batteries Akku 12LCP-60 battery is a special deep cycle battery which is designed for intensive cyclic discharge usage. Because of the very thick lead plates it's possible to achieve more cycles and longer lifetime.

Application:

Electric wheelchair, caravan/marine, cleaning machines, golf cart, vehicle lifts, solar energy system, u.v.m.



Specification:

| | | | |
|------------------------------------|---|-----------------------------------|---------------------------|
| Voltage Per Unit | 12 V | | |
| Capacity | 63 Ah | @20hr-rate to 1.8V per cell @25°C | |
| Cells Per Unit | 6 | | |
| Weight | ca. 20 kg +/- 3% | | |
| Max. Discharge Current | 600 A (5 sec.) | | |
| Internal Resistance | ca. 6.5 m Ω | | |
| Operating Temperature Range Normal | Discharge: - 15°C – 50°C | Charge: -10°C – 50°C | Storage: - 20°C – 50°C |
| Operating Temperature Range | 25°C ± 5°C | | |
| Self Discharge | Valve Regulated Lead Acid (VRLA) batteries can be stored for more than 6 months at 25°C. Self-discharge ratio less than 3% per month at 25°C. Please charge batteries before using. | | |
| Terminal | F11 (M6) | | |
| Container Material | A.B.S. (UL94-HB) | | |

Dimensions:

260 Length x 168 Width x 178 mm Height

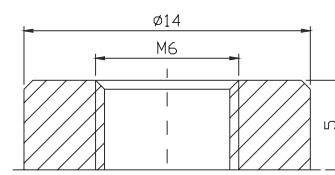
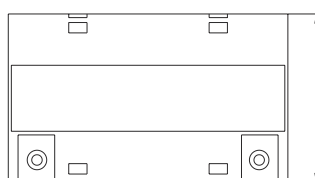
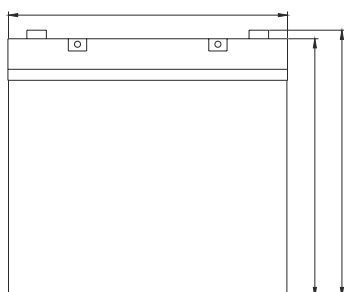

Constant current discharge characteristics: A (25°C)

| FV/Time | 5 Min. | 10 Min. | 15 Min. | 30 Min. | 1 HR | 2 HR | 3 HR | 4 HR | 5 HR | 8 HR | 10 HR | 20 HR |
|---------|--------|---------|---------|---------|-------|-------|-------|-------|-------|------|-------|-------|
| 9.60 V | 201.0 | 148.0 | 115.4 | 70.32 | 39.00 | 23.32 | 16.11 | 13.34 | 11.23 | 7.67 | 6.26 | 3.40 |
| 10.0 V | 195.2 | 140.8 | 113.0 | 69.10 | 38.82 | 23.15 | 16.04 | 13.28 | 11.17 | 7.61 | 6.20 | 3.33 |
| 10.2 V | 189.4 | 135.9 | 111.2 | 67.82 | 28.46 | 22.97 | 15.92 | 13.22 | 11.10 | 7.55 | 6.14 | 3.27 |
| 10.5 V | 170.1 | 125.4 | 105.9 | 67.31 | 38.10 | 22.80 | 15.86 | 13.09 | 10.97 | 7.49 | 6.08 | 3.21 |
| 10.8 V | 153.5 | 114.3 | 97.63 | 66.16 | 37.20 | 22.39 | 15.43 | 12.79 | 10.77 | 7.36 | 6.02 | 3.15 |
| 11.1 V | 131.1 | 102.2 | 87.58 | 61.94 | 35.34 | 21.39 | 14.75 | 12.17 | 10.31 | 7.05 | 5.84 | 2.96 |

Life characteristics of cyclic use:

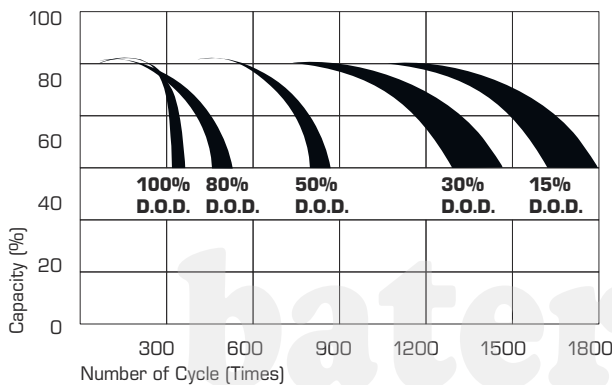

Storage characteristic:

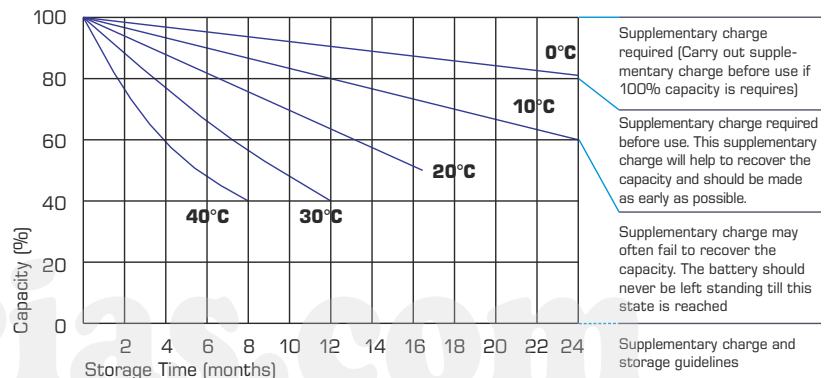

Capacity Factors with different Temperature:

| Battery Type | | -20°C | -10°C | 0°C | 5°C | 10°C | 20°C | 25°C | 30°C | 40°C | 45°C |
|--------------|----------|-------|-------|-----|-----|------|------|------|------|------|------|
| GEL Battery | 6V & 12V | 50% | 70% | 83% | 85% | 90% | 98% | 100% | 102% | 104% | 105% |
| | 2V | 60% | 75% | 85% | 88% | 92% | 99% | 100% | 103% | 105% | 106% |
| AGM Battery | 6V & 12V | 46% | 66% | 76% | 83% | 90% | 98% | 100% | 103% | 107% | 109% |
| | 2V | 55% | 70% | 80% | 85% | 92% | 99% | 100% | 104% | 108% | 110% |

Charging Method:

Charge the batteries at least once every six months, if they are stored at 25°C

| | |
|----------------------|---|
| Constant Voltage (V) | -0.2C x 2h + 2.4-2.45V/Cell x 24h, max. Current 0.3CA |
| Constant Current (A) | -0.2C x 2h + 0.1CA x 12h |
| Fast | -0.2C x 2h + 0.3CA x 4.0h |