



# ES12-12TE

## SPECIFICATIONS

<b>Nominal Voltage (V)</b>	12V
<b>Nominal Capacity</b>	
20 hour rate ( 0.6A to 10.50V )	12Ah
10 hour rate ( 1.14A to 10.50V )	11.4Ah
5 hour rate ( 2.04A to 10.20V )	10.2Ah
1C ( 12A to 9.60V )	6.8Ah
3C ( 36A to 9.60V )	4.8Ah
<b>Weight</b>	Approx. 8.84Lbs. (4.02kg)
<b>Internal Resistance (at 1KHz)</b>	Approx. 11 mΩ
<b>Maximum Discharge Current for 5 seconds :</b>	240A
<b>Operating Temperature Range</b>	
Charge	-15°C ( 5°F ) to 40°C (104°F )
Discharge	-15°C ( 5°F ) to 50°C (122°F )
Storage	-15°C ( 5°F ) to 40°C (104°F )
<b>Charge Retention (shelf life) at 20°C ( 68°F )</b>	
1 month	92%
3 months	90%
6 months	80%
<b>Charging Methods at 25°C ( 77°F )</b>	
<b>Cycle Use :</b>	Charging Voltage 14.4 to 15.0V Coefficient -5.0mv / °C / cell Maximum Charging Current : 3.6A
<b>Standby Use :</b>	Float Charging Voltage 13.50 to 13.80V Coefficient -3.0mv / °C / cell
<b>Case Material :</b>	ABS (Option : UL94 HB Flame Retardant Case Material)
<b>Terminal :</b>	F3

## Maintenance-Free Rechargeable Sealed Lead-Acid Battery



## DIMENSIONS

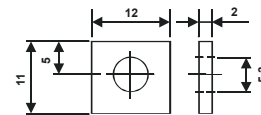

**F3**  
(M5 Bolts)

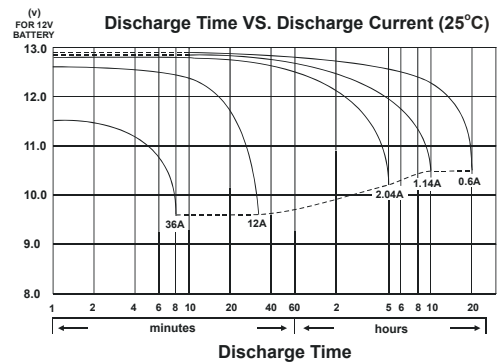
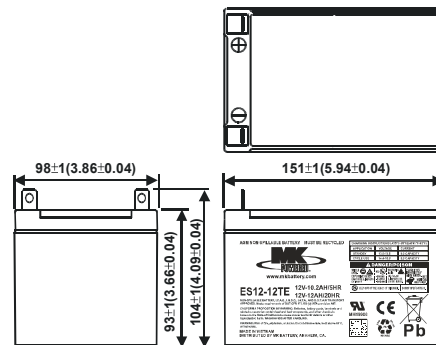

## MK Battery

1631 South Sinclair Street • Anaheim, California 92806

Toll Free: 800-372-9253 • Fax: 714-937-0818 • E-mail: sales@mkbattery.com

