



# M20-12 SLD M

## SPECIFICATIONS

**Nominal Voltage (V)** 12V

### Nominal Capacity

20 hour rate ( 1A to 10.50V )	20Ah
10 hour rate ( 2A to 10.50V )	19Ah
5 hour rate ( 3.4A to 10.20V )	17Ah
1C ( 20A to 9.60V )	9Ah
3C ( 60A to 9.60V )	7.0Ah

**Weight** Approx. 13.31Lbs. (6.05kg)

**Internal Resistance (at 1KHz)** 10 mΩ

**Maximum Discharge Current for 30 seconds :** 400A

**Maximum Discharge Current for 5 seconds :** 800A

### Operating Temperature Range

Charge	0°C (32°F) to 40°C (104°F)
Discharge	-15°C (5°F) to 50°C (122°F)
Storage	-15°C (5°F) to 40°C (104°F)

### Charge Retention (shelf life) at 20°C ( 68°F )

1 month	92%
3 months	90%
6 months	80%

### Charging Methods at 20°C ( 68°F )

**Cycle Use :** Charging Voltage 14.4 to 15.0V  
Maximum Charging Current : 6A

**Standby Use :** Float Charging Voltage 13.50 to 13.80V

### Life expectancy :

**Cycle Use :** 100% depth of discharge 200 cycles  
80% depth of discharge 225 cycles  
50% depth of discharge 500 cycles

**Standby Use :** 3-5 years

### Case Material :

ABS  
(Option : 94-HB & 94V-0 Flame Retardant Case Material)

### Terminal :

F3

## Maintenance-Free Rechargeable Sealed Lead-Acid Battery



## DIMENSIONS

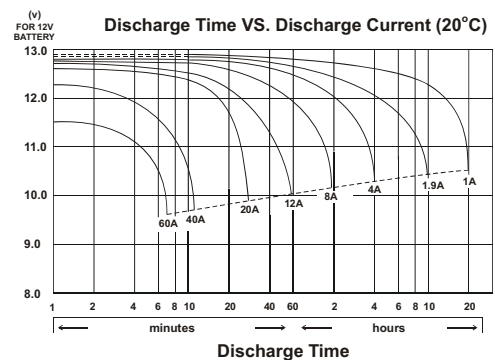
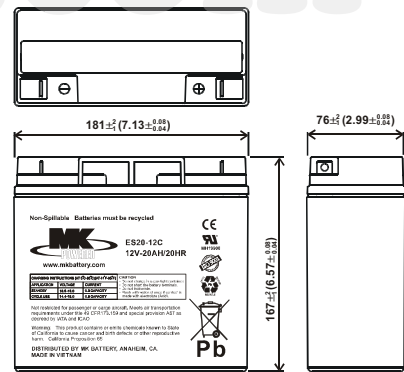
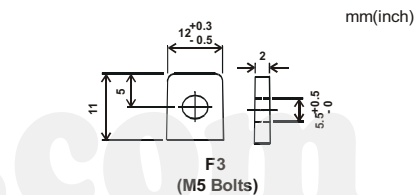

## MK Battery

1631 South Sinclair Street • Anaheim, California 92806

Toll Free: 800-372-9253 • Fax: 714-937-0818 • E-mail: sales@mkbattery.com

